

**PULP BALE CLAMPS
RECYCLING CLAMPS
FOAM CLAMPS**

S15

Bale clamps enable handling of bales of pulp, paper and textiles.

Pulp bale clamps have solid, slim arms to facilitate handling of extremely tightly stacked goods. For better grip, the contact surfaces are equipped with end-to-end bars. Combining attachments with a rotator allows the inversion of bales.

There are especially profiled handle bars mounted to the slim arms of the recycling clamp. This allows different product qualities to be picked up safely in the recycling sector.

The arms of foam clamps are made of hoop-shaped tubular material for careful handling of foam bales. The opening range compared to bale clamps is wider.

S15



Pulp Bale Clamps Model S 15 - BKZ

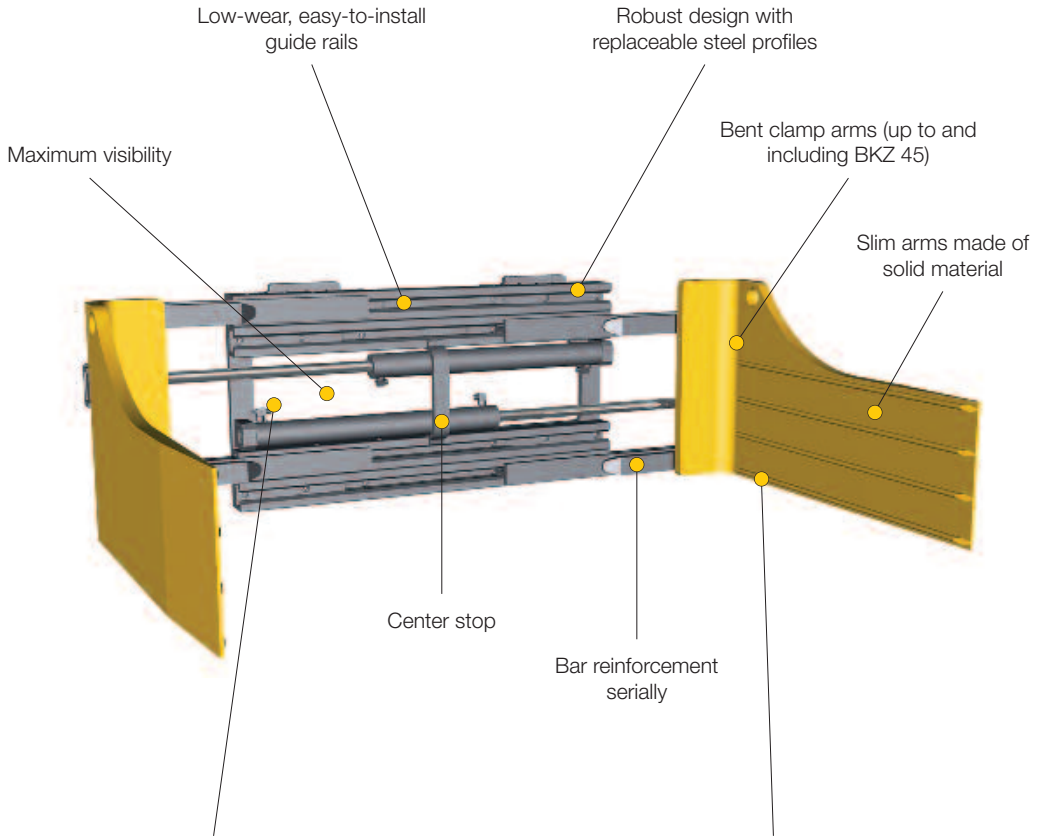

Bumpers in front of the hydraulic connections of the cylinders (optional)

Wear strips below clamp body and clamp arms (optional)



S15

Pulp Bale Clamps, Rotatable

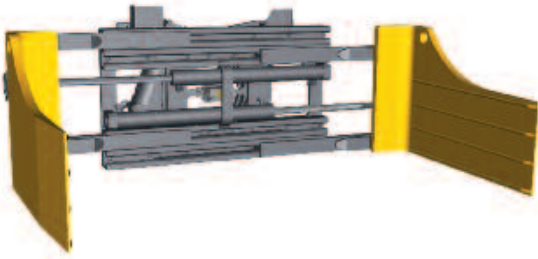

Model S 15 - BKZ ... 360°

- Rotation range of 360° continuous by means of a worm gear
- Protected lateral drive
- Center stop
- Excellent visibility due to low height
- Large centered opening enables good visibility

Recycling Clamps

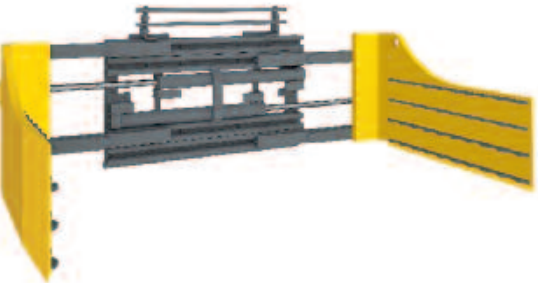

Model S 15 - BKZR

- Arm with corrugated profile
- Wear strips below clamp body and clamp arms serially
- Center stop
- Bumpers in front of the hydraulic connections of the cylinders serially

Foam Clamps

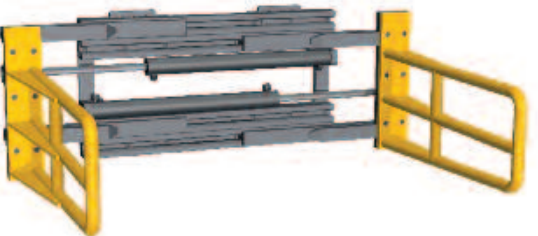

Model S 15 - BKS

- Clamping arms made of hoop-shaped tubular material
- Bolt-on arms
- Bar reinforcement serially
- Damage-free clamping

Pulp Bale Clamps with Sideshift Valve

2 hydraulic functions

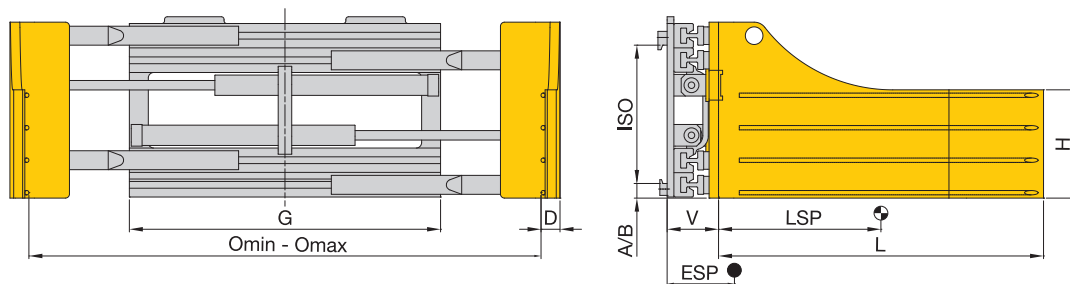

Incl. center stop · bent clamp arms up to BKZ 45-SV

Model	Load capacity	LC (LSP)	ISO	Omin-Omax	G	L	H	D	V	CoG (ESP)	Weight	Price	Surcharge per 100 mm arm length/height
	kg	mm		mm	mm	mm	mm	mm	mm	mm			
S 15 - BKZ 15-SV	1500	500	2	500-1560	950	800	400	30	160	195	385		
				560-1720	1050	800	400	30	160	190	395		
				560-1790	1050	800	400	30	160	190	395		
S 15 - BKZ 22-SV	2200	500	2	560-1830	1150	1000	400	46	185	255	610		
				560-1890	1150	1000	400	46	185	255	615		
				650-2020	1250	1000	400	46	185	250	625		
S 15 - BKZ 28-SV	2800	500	3	560-1830	1150	1000	400	51	190	270	670		
				560-1890	1150	1000	400	51	190	270	675		
				650-2020	1250	1000	400	51	190	265	690		
S 15 - BKZ 35-SV	3000	600	3	560-1900	1250	1200	400	51	200	300	815		
				560-2000	1250	1200	400	51	200	300	820		
				560-2100	1350	1200	400	51	200	295	830		
S 15 - BKZ 40-SV	3900	600	3	560-2100	1350	1200	400	51	200	295	835		
				650-2190	1450	1200	400	51	200	290	860		
				650-2380	1450	1200	400	51	200	290	870		
S 15 - BKZ 45-SV	4200	600	4	560-2000	1350	1200	400	56	205	315	885		
				560-2100	1350	1200	400	56	205	315	890		
				650-2190	1450	1200	400	56	205	310	920		
				650-2380	1450	1200	400	56	205	305	930		
S 15 - BKZ 45-SV	4200	600	4	560-2000	1350	1200	400	56	205	310	990		
				560-2100	1350	1200	400	56	205	310	995		
				650-2190	1450	1200	400	56	205	305	1035		
				650-2380	1450	1200	400	56	205	300	1045		

S15

Pulp Bale Clamps with Sideshift Valve

2 hydraulic functions

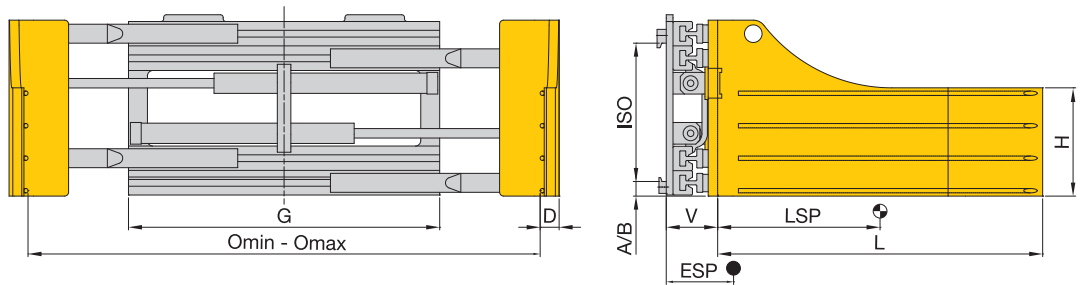

Incl. center stop

Model	Load capacity	LC (LSP)	ISO	Omin-Omax	G	L	H	D	V	CoG (ESP)	Weight	Price	Surcharge per 100 mm arm length/height
S 15 - BKZ 50-SV	5000	600	4	650-2490	1600	1200	400	61	225	285	1335		
				650-2650	1750	1200	400	61	225	265	1455		
S 15 - BKZ 70-SV	5700	700	4	650-2650	1750	1400	500	66	225	355	1665		
				650-2900	2000	1400	500	66	225	340	1745		
S 15 - BKZ 80-SV	6500	800	4	670-2800	2000	1600	600	70	260	400	2360		
				670-3000	2200	1600	600	70	260	390	2445		
S 15 - BKZ 100-SV	8000	800	4	700-3100	2400	1600	600	80	265	390	2665		

- Surcharge for wear strips below clamp body and clamp arms
 - up to BKZ 22-SV
 - up to BKZ 40-SV
 - up to BKZ 70-SV
 - up to BKZ 100-SV on request.
- Surcharge for bumpers in front of the connections of the adjusting cylinders
 - up to BKZ 22-SV
 - up to BKZ 40-SV
 - up to BKZ 70-SV
 - up to BKZ 100-SV on request.
- Surcharge for adjustable pressure relief valve
- Surcharge for pressure gauge
- Surcharge for load backrest see page 211
- Version with one oscillating arm on request.
- Further opening ranges and higher load capacities on request.
- Details on sideshift valve, see page 9
- Available without sideshift
- The opening range between the clamp arms is measured on the frame.
 - Due to a prestress (1°) the opening range between the tips is correspondingly smaller.

See page 148 for standard values for the residual load capacity of lift trucks.

Standard values for residual load capacity of lift trucks**

Pulp Bale Clamps (see page 146/147)

Pulp Bale Clamps with Sideshift Valve	S 15 -	BKZ 15-SV	BKZ 15-SV	BKZ 22-SV	BKZ 22-SV	BKZ 28-SV	BKZ 28-SV	BKZ 35-SV	BKZ 35-SV	BKZ 40-SV	BKZ 40-SV	BKZ 45-SV	BKZ 50-SV	BKZ 70-SV
Load capacity lift truck	kg	1500	2000	2000	2500	3000	3500	4000	4500	4500	5000/500	5000	6000	7000
X*	mm	350	450	450	450	450	500	500	500	500	500	560	560	650
LC (LSP) = 500 mm	kg	1150	1635	1440	1875	2255	2735	3035	3470	3400	3895	4300	4980	6030
LC (LSP) = 600 mm	kg	1045	(1380)	1320	1715	2065	2515	2795	3195	3130	3585	3970	4600	5600
LC (LSP) = 800 mm	kg	880	(1030)	1130	1470	1770	(1925)	2410	(2475)	2700	3090	3445	4000	4900

** The load capacity applies to lifting heights up to 3300 mm; specifications for greater lifting heights on request.

* Assumed dimensions

- For greater load centers, where the lift truck has a higher residual load capacity than the attachment, those values, upon the exceedance of which the attachment would be overloaded, are indicated in brackets ().

Special Products

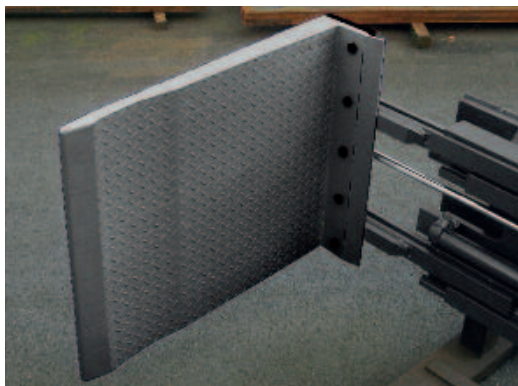

S15

Pulp Bale Clamps, Rotatable

2 hydraulic functions

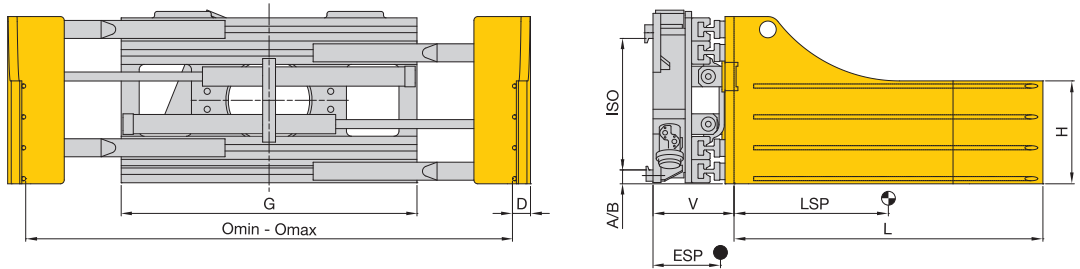

Incl. center stop · Bent clamp arms · Rotation range 360°

Model	Load capacity	LC (LSP)	ISO	Omin-Omax	G	L	H	D	V	CoG (ESP)	Weight	Price	Surcharge per 100 mm arm length or height	Surcharge for sep. Sideshift
	kg	mm												
S 15 - BKZ 15-360°	1500	500	2	560-1720	1050	800	400	30	280	215	635			
S 15 - BKZ 22-360°	2200	500	2	560-1890	1150	1000	400	46	290	280	790			
S 15 - BKZ 28-360°	2800	500	3	560-1890	1150	1000	400	51	315	295	930			
S 15 - BKZ 35-360°	3000	600	3	560-2100	1350	1200	400	51	335	325	1150			

- Surcharge for wear strips under clamp body and arms up to BKZ 22-360°
- Surcharge for wear strips under clamp body and arms up to BKZ 35-360°
- Surcharge for bumpers in front of the connections of the adjusting cylinders up to ISO 2
- Surcharge for bumpers in front of the connections of the adjusting cylinders up to ISO 3
- Surcharge for adjustable pressure relief valve
- Surcharge for pressure gauge
- Surcharge for solenoid valve with separate sideshift incl. hydraulics safety bar (utilization of only rotation/sideshift admissible)
- Further opening ranges on request.
- Higher load capacities on request.
- The opening range between the clamp arms is measured on the frame.
Due to a prestress (1°) the opening range between the tips is correspondingly smaller.

Standard values for residual load capacity of lift trucks**

Pulp Bale Clamps, Rotatable	S 15 -	BKZ 15-360°	BKZ 15-360°	BKZ 22-360°	BKZ 28-360°	BKZ 28-360°	BKZ 35-360°	BKZ 35-360°	BKZ 35-360°
Load capacity lift truck	kg	1500	2000	2500	3000	3500	4000	4500	5000/500
X*	mm	350	450	450	450	500	500	500	500
LC (LSP) = 500 mm	kg	900	1330	1590	1860	2300	2500	2890	3330
LC (LSP) = 600 mm	kg	820	1230	1470	1720	2130	2315	2680	3090
LC (LSP) = 800 mm	kg	710	(1030)	1275	1495	1860	2025	2340	(2480)

** The load capacity applies to lifting heights up to 3300 mm; specifications for greater lifting heights on request.

* Assumed dimensions

- For greater load centers, where the lift truck has a higher residual load capacity than the attachment, those values, upon the exceedance of which the attachment would be overloaded, are indicated in brackets ().

Recycling Clamps with Sideshift Valve

2 hydraulic functions

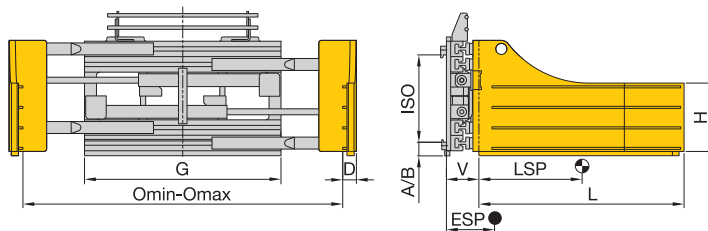

Wear strips serially below the clamp body and clamp arms as well as a center stop and bumpers in front of the hydraulic connections.

Model	Load capacity	LC (LSP)	ISO	Omin-Omax	G	L	H	D	V	CoG (ESP)	Weight	Price	Surcharge per 100 mm arm length/height
	kg			mm	mm	mm	mm	mm	mm	mm			
S 15 - BKZR 15-SV	1500	500	2	470-1530	950	1000	400	45	160	250	445		
				530-1690	1050	1000	400	45	160	245	455		
				530-1760	1050	1000	400	45	160	245	455		
S 15 - BKZR 22-SV	2200	500	2	530-1800	1150	1000	400	60	185	255	650		
				530-1860	1150	1000	400	60	185	255	655		
				620-1990	1250	1000	400	60	185	250	665		
				620-2140	1250	1000	400	60	185	250	670		
S 15 - BKZR 28-SV	2800	500	3	530-1800	1150	1000	400	65	190	270	710		
				530-1860	1150	1000	400	65	190	270	715		
				620-1990	1250	1000	400	65	190	265	730		
				620-2140	1250	1000	400	65	190	265	735		
S 15 - BKZR 35-SV	3000	600	3	530-1870	1250	1200	400	65	200	300	865		
				530-1970	1250	1200	400	65	200	300	870		
				530-1970	1350	1200	400	65	200	295	880		
				530-2070	1350	1200	400	65	200	295	885		
				620-2160	1450	1200	400	65	200	290	910		
S 15 - BKZR 40-SV	3900	600	3	530-1970	1350	1200	400	70	205	315	935		
				530-2070	1350	1200	400	70	205	315	940		
				620-2160	1450	1200	400	70	205	310	970		
				620-2350	1450	1200	400	70	205	305	980		
S 15 - BKZR 45-SV	4200	600	4	520-1960	1350	1200	400	75	205	310	1045		
				520-2060	1350	1200	400	75	205	310	1050		
				610-2150	1450	1200	400	75	205	305	1095		
				610-2340	1450	1200	400	75	205	300	1105		

- Surcharge for adjustable pressure relief valve
- Surcharge for pressure gauge
- Further opening ranges on request.
- Details on sideshift valve, see page 9
- Available without sideshift

- Model BKR (wide arms with ribbed contact surfaces) on request.
- The opening range between the clamp arms is measured on the frame. Due to a prestress (1°) the opening range between the tips is correspondingly smaller.

Standard values for residual load capacity of lift trucks**

Recycling Clamps (see page 150)

Recycling Clamps with Sideshift Valve	S 15 -	BKZR 15-SV	BKZR 15-SV	BKZR 22-SV	BKZR 22-SV	BKZR 28-SV	BKZR 28-SV	BKZR 35-SV	BKZR 35-SV	BKZR 40-SV	BKZR 40-SV	BKZR 45-SV
Load capacity lift truck	kg	1500	2000	2000	2500	3000	3500	3500	4000	4500	5000/500	5000
X*	mm	350	450	450	450	450	500	500	500	500	500	560
LC (LSP) = 500 mm	kg	1100	1580	1415	1850	2230	2710	2570	3005	3365	3865	4265
LC (LSP) = 600 mm	kg	995	(1380)	1300	1695	2045	2495	2365	2765	3100	3555	3940
LC (LSP) = 700 mm	kg	910	(1180)	1200	1565	1890	(2200)	2190	2560	2870	3290	3660

** The load capacity applies to lifting heights up to 3300 mm; specifications for greater lifting heights on request.

* Assumed dimensions

- For greater load centers, where the lift truck has a higher residual load capacity than the attachment, those values, upon the exceedance of which the attachment would be overloaded, are indicated in brackets ().

Bale Clamps in Use



S15



Foam Clamps

1 hydraulic function

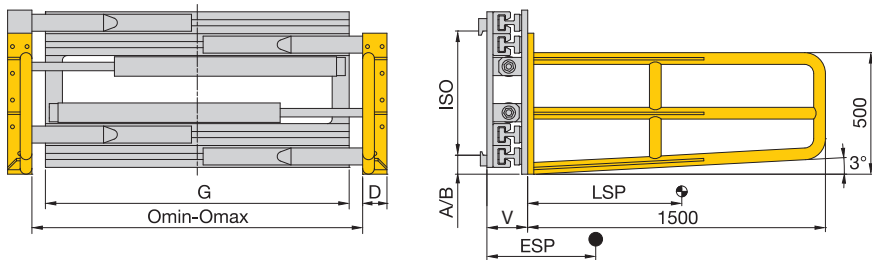

Clamp arms serially bolted on

Model	Load capacity	LC (LSP)	ISO	Omin-Omax	G	D	V	CoG (ESP)	Weight	Price	Surcharge per 100 mm arm length or height
	kg	mm		mm	mm	mm	mm	mm	kg		
S 15 - BKS 10	600	800	2	700-1600	950	100	155	225	385		
S 15 - BKS 10	600	800	2	800-2200	1150	100	155	205	440		
S 15 - BKS 10	600	800	2	850-2430	1250	100	155	200	465		
S 15 - BKS 10	600	800	2	850-2610	1350	100	155	195	490		
S 15 - BKS 15	950	800	2	780-2260	1150	100	155	215	445		
S 15 - BKS 15	950	800	2	800-2380	1250	100	155	210	470		
S 15 - BKS 15	950	800	2	800-2500	1350	100	155	200	510		
S 15 - BKS 15	950	800	2	600-2360	1450	100	155	195	535		
S 15 - BKS 15	950	800	2	850-2610	1450	100	155	195	540		

- Surcharge for sideshift valve S 15 - BKS ... SV
- Surcharge for adjustable pressure relief valve
- Surcharge for pressure gauge
- Further opening ranges on request.
- Version with separate sideshift on request.
- Rotatable version on request.

- Details on sideshift valve, see page 9
- The opening range between the clamp arms is measured on the frame. Due to a prestress (1°) the opening range between the tips is correspondingly smaller.

Standard values for residual load capacity of lift trucks**

Foam Clamps	S 15 -	BKS 10	BKS 10	BKS 15	BKS 15
Load capacity lift truck	kg	1000	1200	1500	2000
X*	mm	300	350	350	450
LC (LSP) = 600 mm	kg	620	800	1020	(1395)
LC (LSP) = 800 mm	kg	520	(660)	860	(950)
LC (LSP) = 1000 mm	kg	450	(530)	740	(835)

** The load capacity applies to lifting heights up to 3300 mm; specifications for greater lifting heights on request.

* Assumed dimensions

- For greater load centers, where the lift truck has a higher residual load capacity than the attachment, those values, upon the exceedance of which the attachment would be overloaded, are indicated in brackets ().